

GRANITE POSTS

Granite posts are the most desirable.

The ideal method of plaque attachment to the granite post is to sandblast a pocket, into which the plaque fits. Then “Stone Epoxy” or masonry anchors can be used to permanently fix the plaque into the pocket. If “Stone Epoxy” is used, the back face of the plaque must be roughened with 80 grit sandpaper, or equivalent, to enhance epoxy adhesion.

Note: Local granite suppliers, such as Gate City Monument, can perform any/all of these services, either at their shop or with their standard mobile equipment.

TREX POSTS

Trex are posts composed primarily of recycled plastic. A drawback is that there are limited post sizes, and the posts are more expensive than pressure treated wood. The lifespan appears to be comparable or better than pressure treated.

Preferred post size: 4” x 6” x 8’ (any color). This post should be installed a minimum of 3’ into the ground. The top 1’ should be cut off, so that the post is approximately 4’ above the ground. The plaque is to be mounted near the top of the post.

Optional post size: 4” x 4” x 52” rail post (any color). This post should be mounted 2’ into the ground. The top edge of the post

should be cut on an angle, so that the plaque can be mounted on the angled edge, without either the top or bottom of the plaque over-hanging the post. Four mounting fasteners (one in each corner) are preferred instead of two mounting fasteners.

Mounting fasteners: Four #8 x ¾” long (or equivalent) stainless steel screws are preferred.

Mounting suggestions: Pre-drill the four holes with a .110” drill or equivalent. After tightening the screws and securing the plaque, grind screw head to prevent tampering, if vandalism is a possibility.

Note: Trex posts are available from local suppliers, such as Belletetes Lumber. Additional information is available at www.trex.com.

ALKALINE COPPER QUATERNARY (ACQ OR QUAT) PRESSURE TREATED POSTS

Unlike regular pressure treated posts, Quat pressure treated posts do not contain arsenic. Installing Quat posts in wet areas does not result in harmful products leaching into the soil. Quat posts are not as expensive as Trex, and are available in a greater variety of sizes, but currently have limited local suppliers.

The mounting requirements and suggestions for Quat treated lumber are identical to the requirements and suggestions for Trex.

Additional information on Quat treated lumber is available at www.westernwoodpreserving.com.

BOULDERS

Boulders must meet the NCC approval, and shall be sound, durable rock that is angular, or sub-angular.

The average diameter for the rock must be greater than 24”. A minimum of one-half of the rock must be situated below grade. (This prevents the unwanted movement of the boulder.)

The rock shall be shaped so that the least dimension of the rock shall not be less than one-third of the greatest dimension of the rock. Flat or soft rock shall not be used for signposts.

The rock must be sandblasted so that a pocket is formed, approximately 1/16” deep, in to which the plaque can be fixed. The plaque shall be fixed into the pocket via as described under ‘Granite Posts’ listed above.

~~~~~

*Please note that wetlands and wetland buffers are protected under NH State laws (RSA 674:16-17) and Nashua laws (Nashua Revised Ordinances 16-571 thru 16-575). Any disturbance to a wetland and/or wetland buffer requires a “Special Exception” from the Zoning Board of Adjustment (ZBA).*

*Prior to consideration by ZBA, the NCC must review the plans. The NCC then passes a favorable or unfavorable recommendation to ZBA.*

*Wetlands need to be flagged by a licensed wetlands scientist and buffers need to be measured by an engineer or surveyor.*

## MOUNTED PLAQUES EXAMPLES

Mounted on the face of a post:

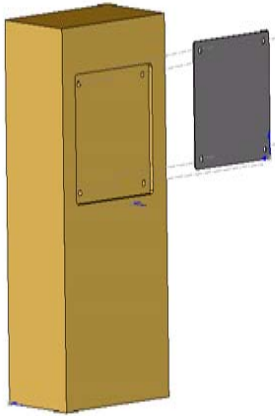

Mounted on the top of a post (angle cut):

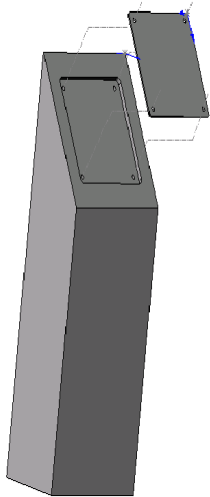

The Nashua Conservation Commission has prepared this guide to help you install effective and permanent plaques. For more information, contact:

**Nashua Conservation Commission**  
**Community Development Division**  
**City Hall, 2<sup>nd</sup> floor**  
**229 Main Street**  
**PO Box 2019**  
**Nashua, NH 03061-2019**  
**(603) 589-3105**  
[www.ci.nashua.nh.us](http://www.ci.nashua.nh.us) or  
[www.gonashua.com](http://www.gonashua.com)



*The Nashua Conservation Commission was established for the proper utilization, preservation, and protection of the natural and watershed resources that have been found to be vital to the public good and welfare.*

## REQUIREMENTS FOR CONSTRUCTION AND INSTALLATION OF

### ‘Conservation Easement’ ‘Wetland Buffer’ ‘Conservation Land’ PLAQUES

If installation of one or more of the above plaques is required by the Nashua Conservation Commission (NCC), the following guidelines must be met:

- The plaque installation must be clearly visible and permanent. The plaques must face outward.
- The small metal plaque with the ‘Conservation Easement’, ‘Wetland Buffer’, or ‘Conservation Land’ wording is available for purchase from the NCC.
- Due to the environmentally harsh preservatives used in the pressure treating process, the NCC does not permit regular pressure treated lumber.
- The NCC requires granite, Trex or Quat posts. The NCC can discuss proposed alternative post materials if the applicant requests. If an applicant is considering any other post, it must first be reviewed and approved by the NCC.
- It is illegal to tamper with plaques after installation.